

Chain Washers

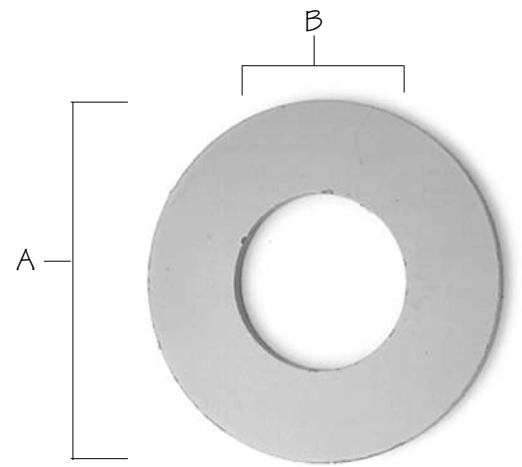

Regular

ITEM #	CHAIN SIZE (IN)	DIAMETER (A) (IN)	HOLE SIZE (B) (IN)	PLATE THICKNESS (IN)	WT./UNIT (LBS)
WS58	5/8	5	2 1/2	3/8	2.6
WS34	3/4	6	3	3/8	3.5

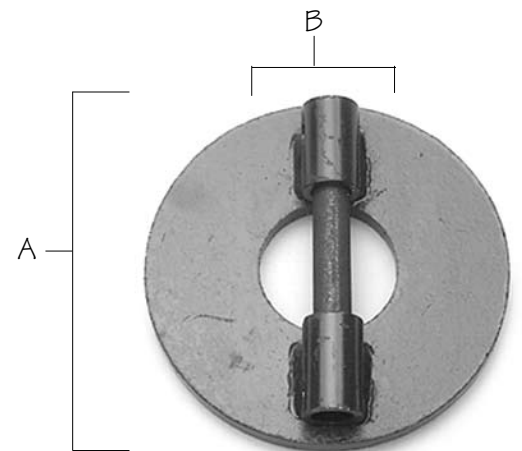

Stop Washer

ITEM #	CHAIN SIZE (IN)	DIAMETER (A) (IN)	HOLE SIZE (B) (IN)	PLATE THICKNESS (IN)	WT./UNIT (LBS)
BMT13	1/2	4 1/2	2	3/8	2.4
BMT16	5/8	6	2 1/2	1/2	4.0
BMT19	3/4	8	2 3/4	1/2	8.3

DANTRAWL
INCORPORATED

MODERN GEAR FOR TODAY'S PROFESSIONAL FISHERMAN

4776 Shilshole Ave. N.W. • Seattle, WA 98107 • Phone: 206-789-8840 • Fax: 206-789-8973 • sales@dantrawl.com

E-3